

Low Voltage Fuse



NT(NH) RT16 series fuses

NT-Fuse link

According to IEC60269, DIN 43620, GB13539 and CE Safety, ROHS certificate.

Rated voltage: AC500V/690V or DC 440V

Rated current: 2A~1250A.

Exception: Size 00 with DC 250V

Operating class:

- ① gL/gG for cable and conductor protection
- ② aM for motor protection
- ③ aR for semiconductor protection

Finely graduated selectivity

Rated breaking capacity: AC120kA(Size 00:AC 50kA)

Technology Parameter

制造等级 Size	In A	订货号 Order No.			图号 Fig.	重量 Weight (g)
		Operating Class(gL/gG)	Operating class(aM)	Operating class(aR)		
NT00C (RT16-00C)	2	002GNT00C	002MNT00C	002RNT00C	Fig.1.1	145
	4	004GNT00C	004MNT00C	004RNT00C		
	6	006GNT00C	006MNT00C	006RNT00C		
	10	010GNT00C	010MNT00C	010RNT00C		
	16	016GNT00C	016MNT00C	016RNT00C		
	20	020GNT00C	020MNT00C	020RNT00C		
	25	025GNT00C	025MNT00C	025RNT00C		
	32	032GNT00C	032MNT00C	032RNT00C		
	35	035GNT00C	035MNT00C	035RNT00C		
	40	040GNT00C	040MNT00C	040RNT00C		
	50	050GNT00C	050MNT00C	050RNT00C		
	63	063GNT00C	063MNT00C	063RNT00C		
	80	080GNT00C	080MNT00C	080RNT00C		
100	100GNT00C	100MNT00C	100RNT00C			

Dimension drawing

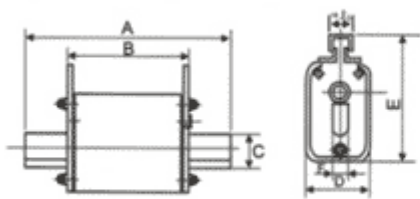

Fig.1.1

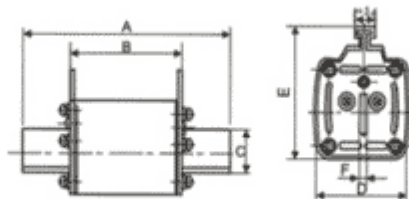

Fig.1.2

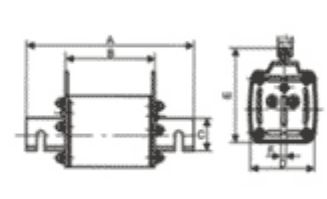

Fig.1.3

序号No.	制造等级 Size	图号Fig.	电流等级 Class rating(A)	尺寸 Dmensions(mm)					
				A	B	C	D	E	F
001	NT00C(NH00C)	Fig.1.1	2 ~ 100	78	49	15	21	52.5	6
002	NT00(NH00)	Fig.1.1	2 ~ 160	78	49	15	28.5	55.5	6
003	NT0(NH0)	Fig.1.2	4 ~ 160	122	65	15	29	55.5	6
004	NT1(NH1)	Fig.1.2	63 ~ 250	135	68	20	48	60	6
005	NT2(NH2)	Fig.1.2	80 ~ 400	150	68	26	60	70.3	6
006	NT3(NH3)	Fig.1.2	300 ~ 630	150	68	32	67	82	6
007	NT4(NH4)	Fig.1.3	630 ~ 1250	200	80	51	85	112	8

Low Voltage Fuse



RTO switch fuse

According to GB 13539 and IEC 269

Rated voltage: AC 400V

Rated current: 2A~1250A

Operating class gL/gG

for cable and conductor protection

Finely graduated selectivity

Rated breaking capacity: AC 50kA

制造等级 Size	I_n A	订货号 Order No. Operating class fgL/gG)	图号 Fig.	重量 Weight (g)
RTO-100	30	030GRTO100	Fig.3.2	310
	40	040GRTO100		
	50	050GRTO100		
	60	060GRTO100		
	80	080GRTO100		
	100	100GRTO100		

Dimension drawing

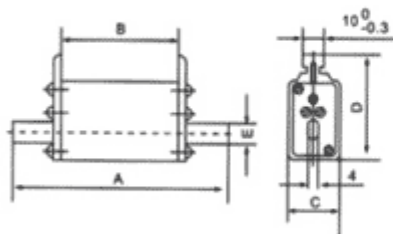

Fig.3.1

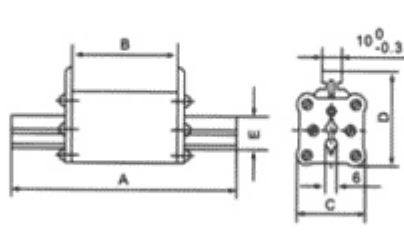

Fig.3.2

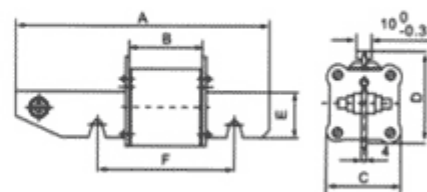

Fig.3.3

序号No.	制造等级 Size	图号Fig.	电流等级 Class rating(A)	尺寸 Dimensions(mm)					
				A	B	C	D	E	F
011	RTO-50	Fig.3.1	10~50	105	62	26	52	11	-
015	RTO-100	Fig.3.2	30~100	123	62	40	52	18	-
016	RTO-200	Fig.3.2	100~200	133	62	46	58	23	-
017	RTO-400	Fig.3.2	200~400	143	62	55	66	30	-
018	RTO-600	Fig.3.2	350~600	163	62	67	78.5	36	-
019	RTO-1000	Fig.3.3	800~1000	280	80	85	102	48	160

Low Voltage Fuse



Cylindrical contact cap fuses

Cylindrical fuse links

According to IEC 269-2, NF C 63 210-63 211-60 200, NBNC 63 269-2 en-2-1 and CEI 32-4

Rated voltage: AC 400V, AC 500V

Operating class:

- ① gL/gG for conductor protection
- ② aM for motor protection
- ③ aR for semiconductor protection

Rated breaking capacity: AC 100 kA

制造等级 Size	In A	订货号 Order No.			图号 Fig.	重量 Weight (g)
		Operating class(gL/gG)	Operating class(aM)	Operating class(aR)		
8.5 × 31.5	0.5	00G0831	00M0831	00R0831	Fig.4.1	4
	1	01G0831	01M0831	01R0831		
	2	02G0831	02M0831	02R0831		
	4	04G0831	04M0831	04R0831		
	6	06G0831	06M0831	06R0831		
	10	10G0831	10M0831	10R0831		
	16	16G0831	16M0831	16R0831		
	20	20G0831	20M0831	20R0831		

Dimension drawing

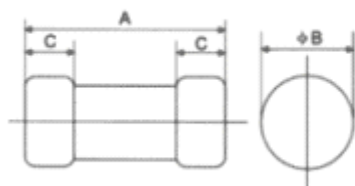

Fig.4.1

序号No.	制造等级 Size	图号Fig.	电流等级 Class rating(A)	尺寸 Dmensions(mm)		
				A	ΦB	C
026	8.5X31.5	Fig.4.1	2-16	31.5	8.5	6.3
027	10X38	Fig.4.1	2-25	38	10.3	10
028	14X51	Fig.4.1	10-40	51	14.3	12
029	22X58	Fig.4.1	25-125	58	22.2	14

Low Voltage Fuse



Cylindrical contact cap fuses

According to IEC 269-2, NF C 63 210-63 211-60 200, NBNC 63 269-2 en-2-1 and CEI 32-4

Rated voltage: AC 400V, AC 500V

Operating class:

- ① gL/gG for conductor protection
- ② aM for motor protection
- ③ aR for semiconductor protection

Rated breaking capacity: AC 100 kA

制造等级 Size	In A	订货号 Order No.			图号 Fig.	重量 Weight (g)
		Operating class(gL/gG)	Operating class(aM)	Operating class(aR)		
8.5×31.5	0.5	00G0831	00M0831	00R0831	Fig.4.1	4
	1	01G0831	01M0831	01R0831		
	2	02G0831	02M0831	02R0831		
	4	04G0831	04M0831	04R0831		
	6	06G0831	06M0831	06R0831		
	10	10G0831	10M0831	10R0831		
	16	16G0831	16M0831	16R0831		
	20	20G0831	20M0831	20R0831		

Dimension drawing

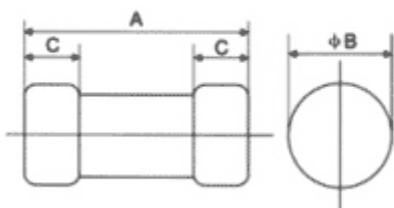

Fig.4.1

序号No.	制造等级 Size	图号Fig.	电流等级 Class rating(A)	尺寸 Dmensions(mm)		
				A	ΦB	C
026	8.5X31.5	Fig.4.1	2~16	31.5	8.5	6.3
027	10X38	Fig.4.1	2~25	38	10.3	10
028	14X51	Fig.4.1	10~40	51	14.3	12
029	22X58	Fig.4.1	25~125	58	22.2	14

Low Voltage Fuse



Screw type fuse

D0-Fuse links

According to DIN VDE 0636, IEC 269

Rated voltage AC 400 V, DC 250V

Operating class gL/gG

For cable and line protection

Finely graded selectivity

High rated short-circuit breaking capacity

Size	I_n A	Colour mark RAL 840 HR	Order No.	Fig.	Weight (g)
D01	2	玫瑰 Rosy	02GD01	Fig.5.2	6
	4	棕 Bronzy	04GD01		
	6	绿 Green	06GD01		
	10	红 Red	10GD01		
	16	灰 Gray	16GD01		
D02	20	兰 Blue	20GD02	Fig.5.2	12
	25	黄 Yellow	25GD02		13
	35	黑 Black	35GD02		14
	50	白 White	80GD02		15
	63	铜 coppery	63GD02		16
D03	80	银 Silver	080GD03	Fig.5.2	40
	100	红 Red	100GD03		42

Dimension drawing

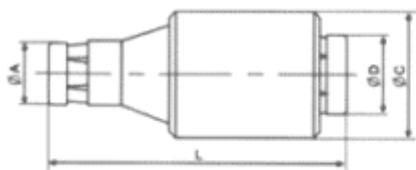

Fig.5.1

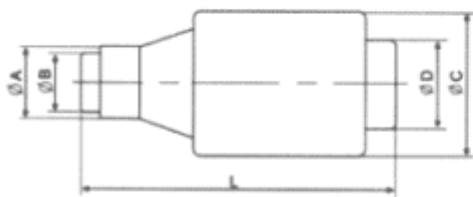

Fig.5.2

用于电工螺纹 For thread	制造等级 Size	电流等级 Class rating(A)	尺寸Dimension(mm)					
			图号 Fig	ϕA	ϕB	ϕC	ϕD	L
E16	DI	2-6	5.1	6	-	12.5	11.3	50
		10	5.1	8	-	12.5	11.3	50
		16	5.1	10	-	12.5	11.3	50
		20-25	5.1	12	-	12.5	11.3	50
E27	DII	2-6	5.1	6	-	21	13	50
		8-10	5.1	8	-	21	13	50
		16	5.1	10	-	21	13	50
		20	5.1	12	-	21	13	50
		25	5.1	14	-	21	13	50
E33	DIII	30-40	5.1	16	-	27	20	50
		50	5.1	18	-	27	20	50
		63	5.1	20	-	27	20	50
D0	D01	2-6	5.2	5	7	12	10	36
		10	5.2	5	8	12	10	36
		16	5.2	5	9	12	10	36
		20	5.2	8.5	11	15	13.5	36
		25	5.2	8.5	12	15	13.5	36
	D02	35	5.2	8.5	13	15	13.5	36
		50	5.2	8.5	14	15	13.5	36
		63	5.2	8.5	16	15	13.5	36
	D03	80	5.2	17	21	22	21	43
		100	5.2	17	25	22	21	43

Low Voltage Fuse



ZGUA

NGT,RSO&FS3 fuse links

NGT-fuse links

According to GB13539 and IEC 269

Dimensions according to DIN 43620,DIN 43653

Rated voltage:AC 500V,AC 690V,AC 1000V

Open rating class gR(aR)

For semiconductor protection

Size	I_n A	Order NO.	Fig.	Weight (g)
With bolt-on lugs Rated voltage:AC 690V				
NGT00	25 32 40 50 63 80 100 125 160	025RNGT00 032RNGT00 040RNGT00 050RNGT00 063RNGT00 080RNGT00 100RNGT00 125RNGT00 160RNGT00	Fig.6.1	185

Dimension drawing

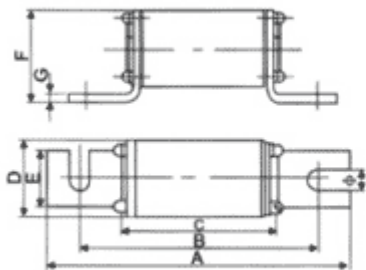

Fig.6.1

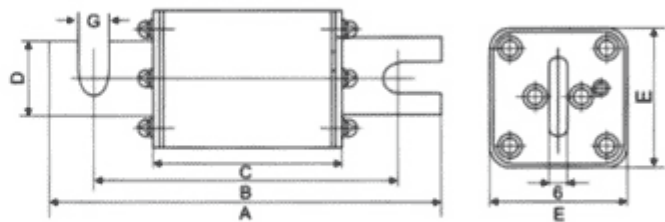

Fig.6.2

序号No.	制造等级 Size	图号Fig.	电流等级 Class rating(A)	尺寸 Dmensions(mm)							
				A	B	C	D	E	F	G	Φ
043	NGT00	Fig.6.1	25~160	100	80	50	28.5	20	47	2	9
044	NGT1	Fig.6.2	80~250	140	110	68	25	48	-	10.5	-
045	NGT2	Fig.6.2	200~400	140	110	68	32	59	-	10.5	-
046	NGT3	Fig.6.2	315~630	140	110	68	38	67	-	10.5	-

Low Voltage Fuse



Bolting type fuse

According to IEC 269,BS88,GB13539

Rated voltage: AC 415V,AC 500V

Operating class

- ① gL/gG for conductor protection
- ② aM for motor protection
- ③ aR for semiconductor protection

Rated breaking capacity: AC 100 kA

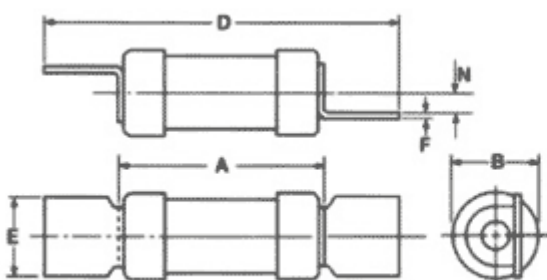

Fig.7.1

制造等级 Size	尺寸 Dimensions(mm) Fig.7.1					
	A	B	D	E	F	N
SSD	23.0	12.0	47.0	13.0	0.8	3.2
NSD & NSD20M	34.5	13.8	58.5	12.7	0.8	3.5
NSD20M36 & NSD32M	34.5	17.5	58.5	12.7	0.8	3.5
ESD-32A	35.5	13.8	68.0	15.0	12	3.5
ESD40-63A	35.5	17.5	68.0	15.0	12	3.5
ESD63M	35.5	21.0	68.0	15.0	12	3.5

Size	<i>I_n</i> A	Operating class	Order No.	Fig.	Weight (g)
SSD	2 4 6 10 16 20 32	gG	ZSSD02 ZSSD04 ZSSD06 ZSSD10 ZSSD16 ZSSD20 ZSSD32	Fig.7.1	16
NSD	2 4 6 10 16 20 32 36 40 50 63	GR	ZNSD02 ZNSD04 ZNSD06 ZNSD10 ZNSD16 ZNSD20 ZNSD32 ZNSD36	Fig.7.1	24
		gM	ZNSD40 ZNSD50 ZNSD63		
ESD	2 4 6 10 16 20 32 40 50 63 80 100	gG	ZESD02 ZESD04 ZESD06 ZESD10 ZESD16 ZESD20 ZESD32 ZESD40 ZESD50 ZESD63	Fig.7.1	85
		gM	ZESD80 ZESD100		
NITD	2 4 6 10 16 20 25 32 40 50 63	gG	ZNITD02 ZNITD04 ZNITD06 ZNITD10 ZNITD16 ZNITD20 ZNITD25 ZNITD32	Fig.7.2	74
		gM	ZNITD40 ZNITD50 ZNITD63		